



A.camineti

ABOUT US



For more than 27 years Acaminetti company from a small Italian family business has developed into a large company that meets all the requirements of customers.

Acaminetti adheres to all standards, simplicity in reliability and refinement in design. A.caminetti has been committed to generating heat conveniently, economically, with environmental responsibility and in accordance with demand. With a wide variety of outstanding product developments and problem-solving solutions, A.Caminetti has created milestones that have often made them the trailblazer and trendsetter for their entire industry. A.Caminetti orientation is decisively international - as it exports in Europe,Asia,Africa

-The quality of the materials made, the ease of operation and reasonable prices will not leave indifferent even the most demanding buyer.

-Glass in A. Caminetti stone furnaces are presented in such types:

- Prismatic glass*
- Flat glass*
- Corner glass*
- 3 side glass (3D)*
- 4 side glass (4D)*





A. Caminetti fireplace inserts have the following characteristics:

- Each model can be order under individual SIZE*
- The fireplaces are made of steel, which provides you with reliable use for decades*
- Guarantee in 5 years will allow you to be calm and confident in the reliability of the company*
- Fuel for briquettes and firewood*
- High power will provide heating even a large room*
- ISO 9001:2008 standards guarantee you quality*

A.caminetti glass model

-  Prizma glass
-  Flat glass
-  3-side glass
-  4-side glass

A.caminetti fireplace have the following characteristic

-  The fireplaces are made of steel, which provides you with reliable use for decades
-  The 5 year warranty will allow you to be calm and confident in the reliability of the company
-  Fuel on briquettes and wood
-  High power will ensure the heating of even a large room
-  The standards of ISO 9001: 2008 provide a quality guarantee



MODELS:

FLAT



PRIZMA



A.caminetti

CRYSTAL

WOOD BURNING FIREPLACES



QUATTRO





FLAT 75 X 50

A.camineti

SERIA Flat

TECHNICAL SPECIFICATION

Model	FLAT 75x50
Power (max)	10-13 kw
Outlet temperature/smoke	230°C
Efficiency	80%
Consume	2-3 Kg/h
Fireplace material	Ceramic / Steel
Fan air supply	100 x 230 mm
Hot air outlet	4 x ø100 mm
Weight	270 kg
Air temperature at outlet	120°C
Fuel	Wood/Briquette
Pipe diameter	ø 200 mm
Glass	Ceramic
Certificate based on standard	UNI EN ISO 9001:2008
Warranty	5 Year

OVERALL DIMENSION

Height	1550 mm
Depth	600 mm
Width	1083 mm

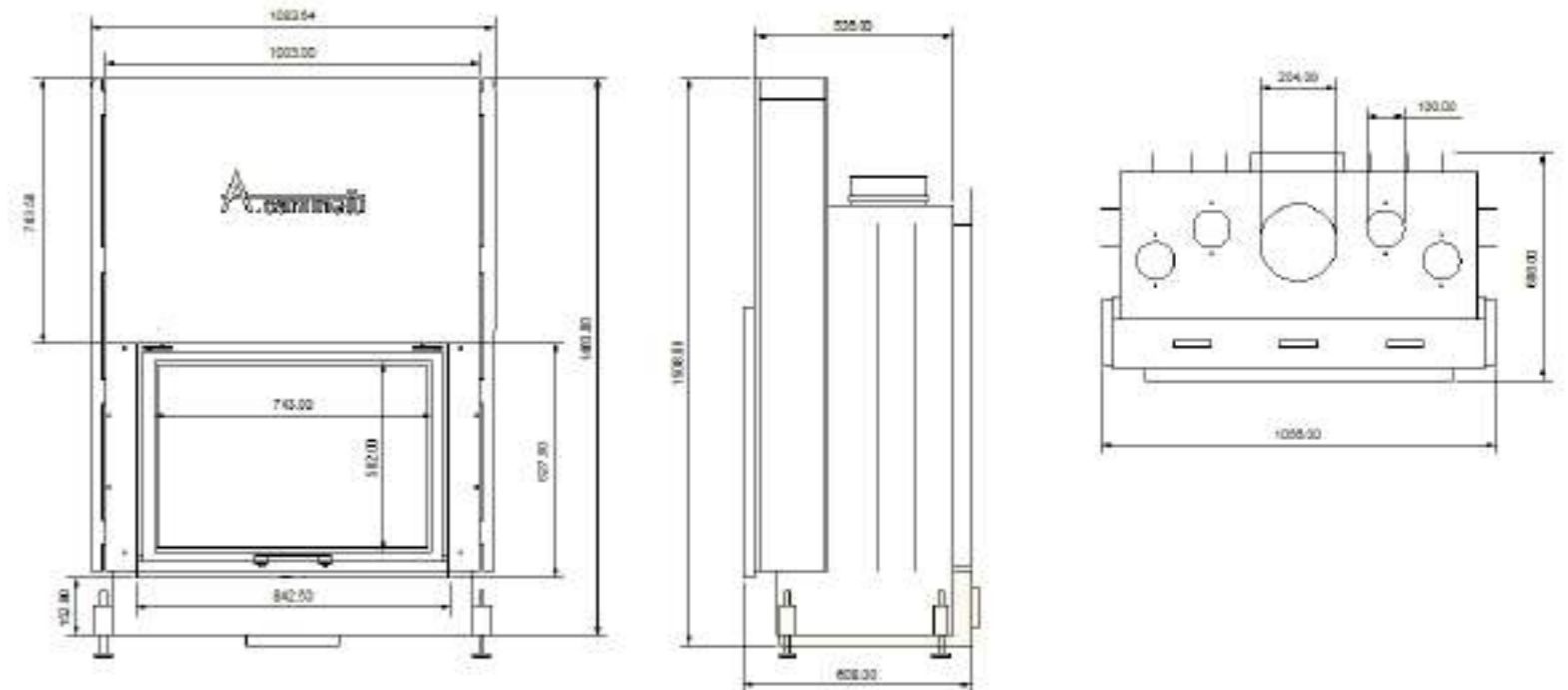

FLAT 75 X 60

A.camineti

SERIA Flat

TECHNICAL SPECIFICATION

Model	FLAT 75x60
Power (max)	10-13 kw
Outlet temperature/smoke	230°C
Efficiency	80%
Consume	3-4 Kg/h
Fireplace material	Ceramic / Steel
Fan air supply	100 x 230 mm
Hot air outlet	4 x ø100 mm
Weight	290 kg
Air temperature at outlet	120°C
Fuel	Wood/Briquette
Pipe diameter	ø 200 mm
Glass	Ceramic
Certificate based on standard	UNI EN ISO 9001:2008
Warranty	5 Year

OVERALL DIMENSION

Height	1550 mm
Depth	600 mm
Width	1083 mm

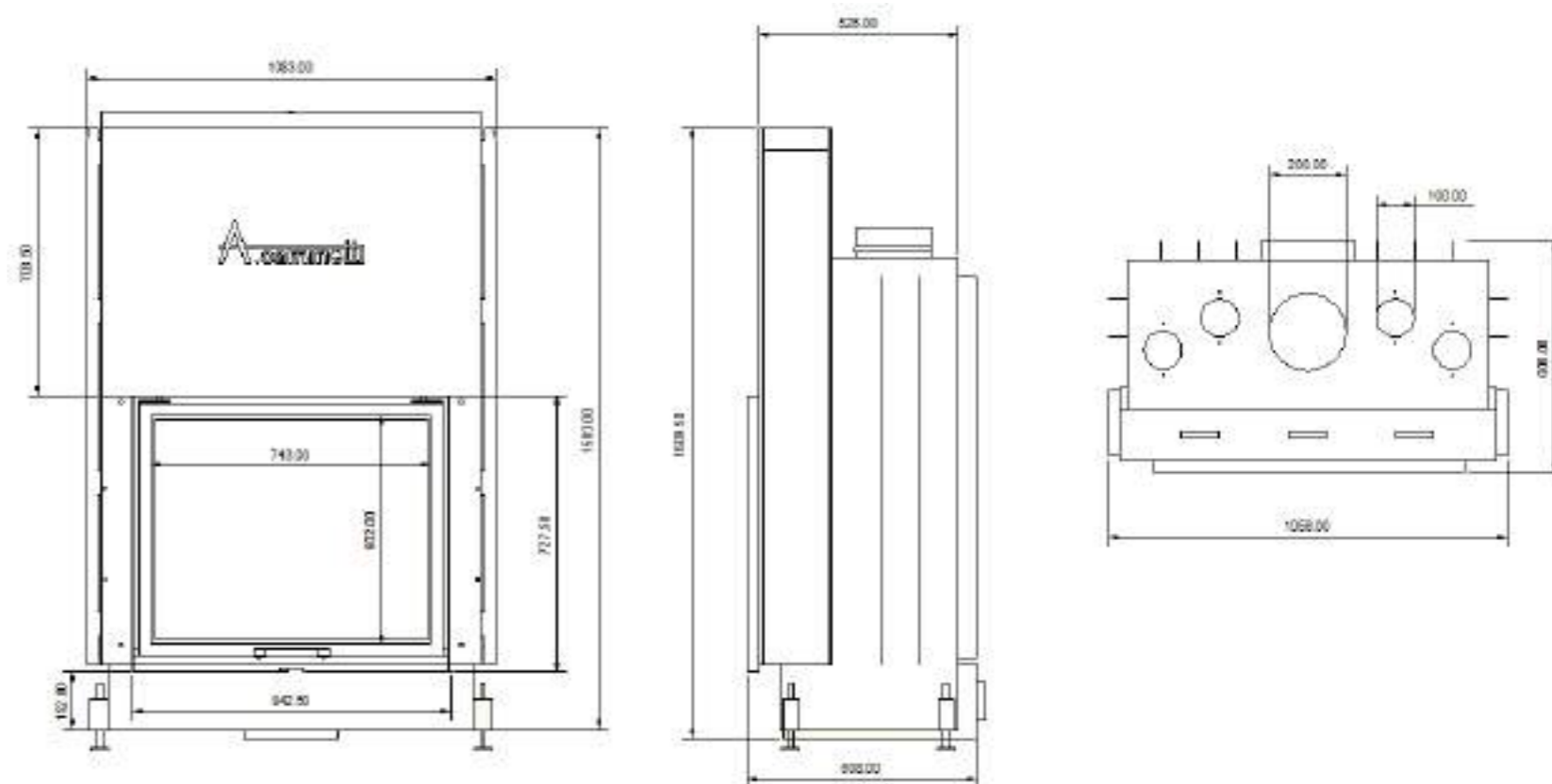

FLAT 90 X 50

A.caminetti

SERIA Flat

TECHNICAL SPECIFICATION

Model	FLAT 90X50
Power (max)	10 -14 kw
Outlet temperature/smoke	240°□
Efficiency	80%
Consume	3-4 Kg/h
Fireplace material	Ceramic / Steel
Fan air supply	100 x 230 mm
Hot air outlet	4 x fi 100 mm
Weight	320 kg
Air temperature at outlet	120°C
Fuel	Wood/Briquette
Pipe diameter	ø 200 mm
Glass	Ceramic
Certificate based on standard	UNI EN ISO 9001:2008
Warranty	5 Year

OVERALL DIMENSION

Height	1550 mm
Depth	600 mm
Width	1233 mm

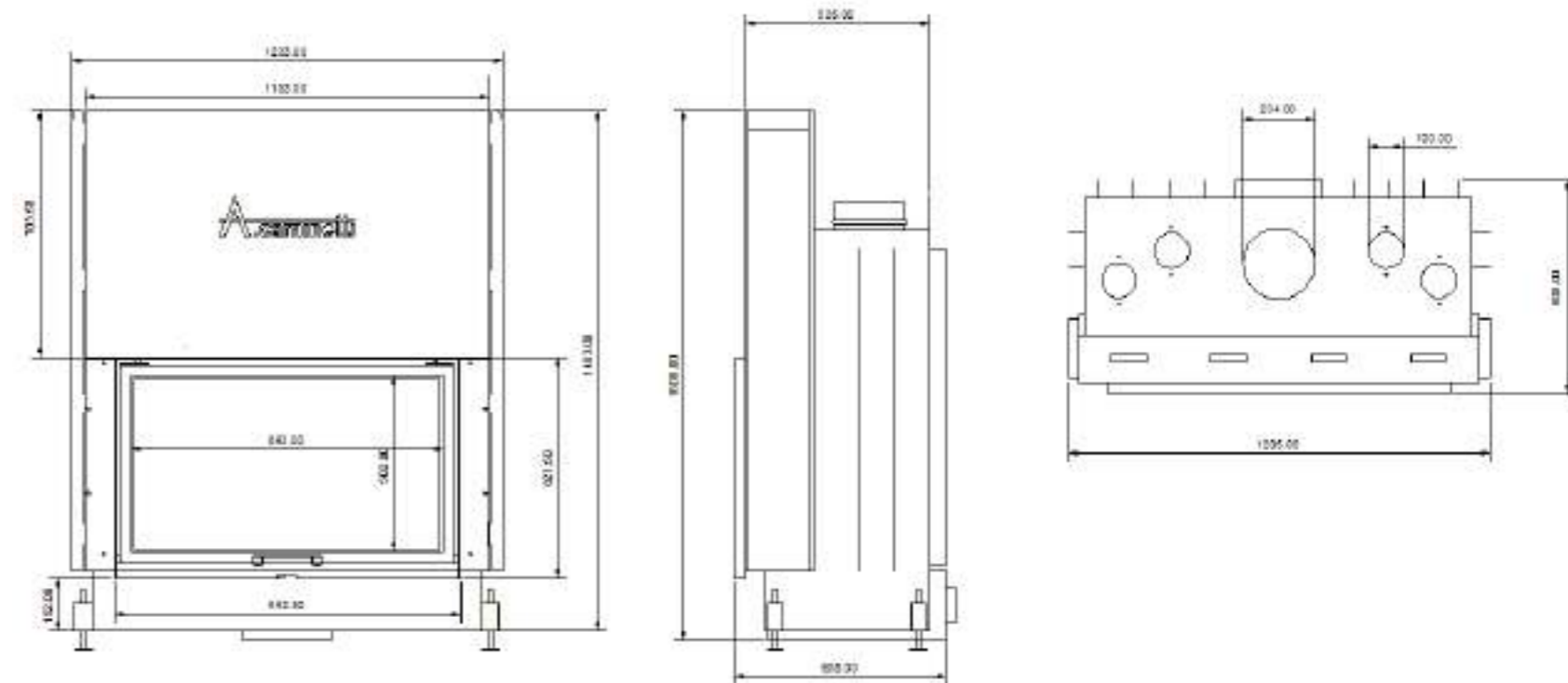

FLAT 90 X 60

TECHNICAL SPECIFICATION

Model	FLAT 90 X 60
Powe (max)	10-14 kw
Outlet temperature/smoke	230°C
Efficiency	80%
Consume	3-4 kg/h
Fireplace material	Ceramic / Steel
Fan air supply	100 x 230 mm
Hot air outlet	4 x ø100 mm
Weight	354 kg
Air temperature at outlet	120°C
Fuel	Wood/Briquette
Pipe diameter	ø 200 mm
Glass	Ceramic
Certificate based on standard	UNI EN ISO 9001:2008
Weight	5 Year

OVERALL DIMENSION

Height	1550 mm
Depth	600 mm
Width	1233 mm

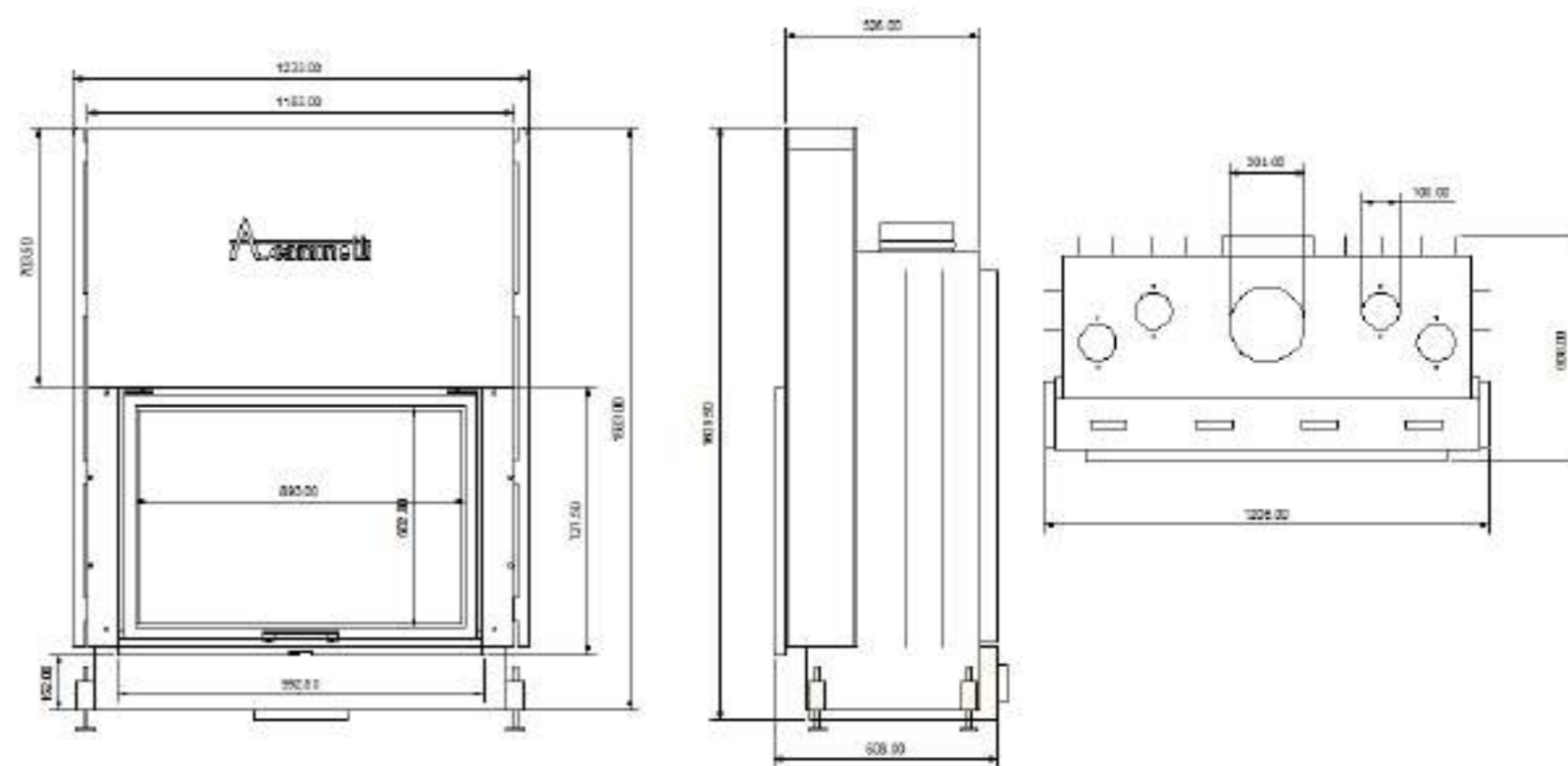

FLAT 90 X 70

A.caminetti

SERIA Flat

TECHNICAL SPECIFICATION

Model	FLAT 90 X 70
Powe (max)	11-15 kw
Outlet temperature/smoke	240°C
Efficiency	80%
Consume	3-4 kg/h
Fireplace material	Ceramic / Steel
Fan air supply	100 x 230 mm
Hot air outlet	4 x ø100 mm
Weight	374 kg
Air temperature at outlet	120°C
Fuel	Wood/Briquette
Pipe diameter	ø 200 mm
Glass	Ceramic
Certificate based on standard	UNI EN ISO 9001:2008
Weight	5 Year

OVERALL DIMENSION

Height	1650 mm
Depth	600 mm
Width	1233 mm

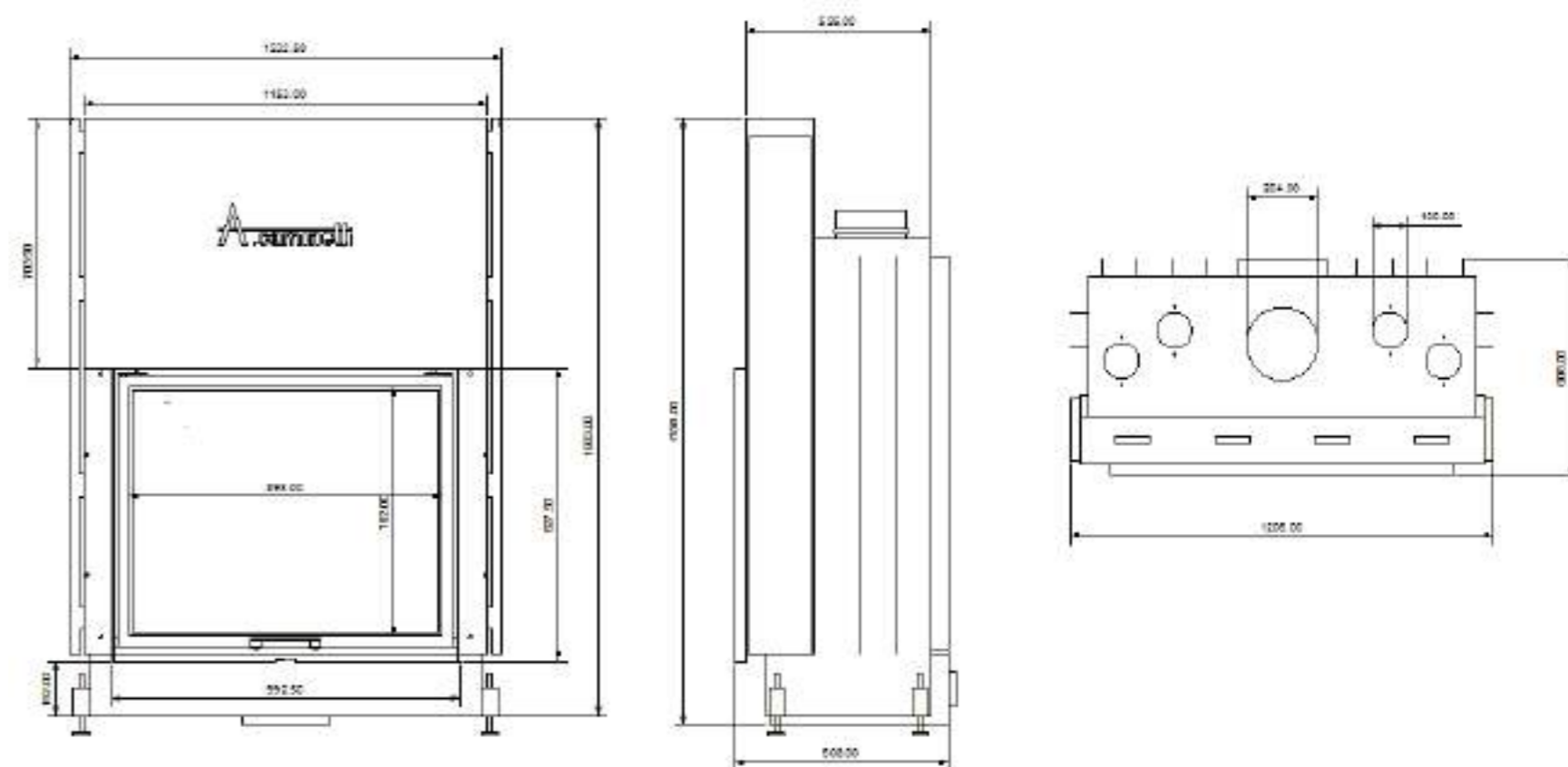

FLAT 120X50

A.caminetti

SERIA Flat

TECHNICAL SPECIFICATION

Model	FLAT 120X50
Powe (max)	18 kw
Outlet temperature/smoke	240°C
Efficiency	80%
Consume	3-4 kg/h
Fireplace material	Ceramic / Steel
Fan air supply	100 x 230 mm
Hot air outlet	4 x ø100 mm
Weight	400 kg
Air temperature at outlet	120°C
Fuel	Wood/Briquette
Pipe diameter	ø 250 mm
Glass	Ceramic
Certificate based on standard	UNI EN ISO 9001:2008
Weight	5 Year

OVERALL DIMENSION

Height	1500 mm
Depth	600 mm
Width	1453 mm

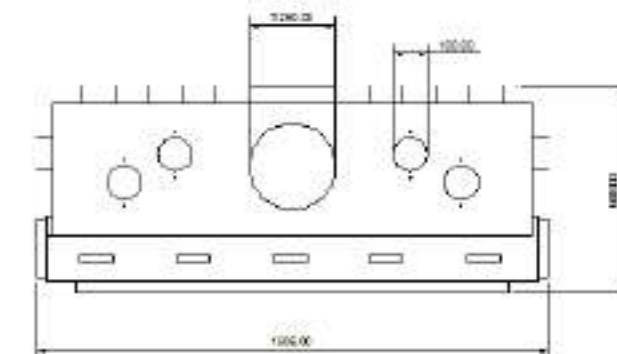
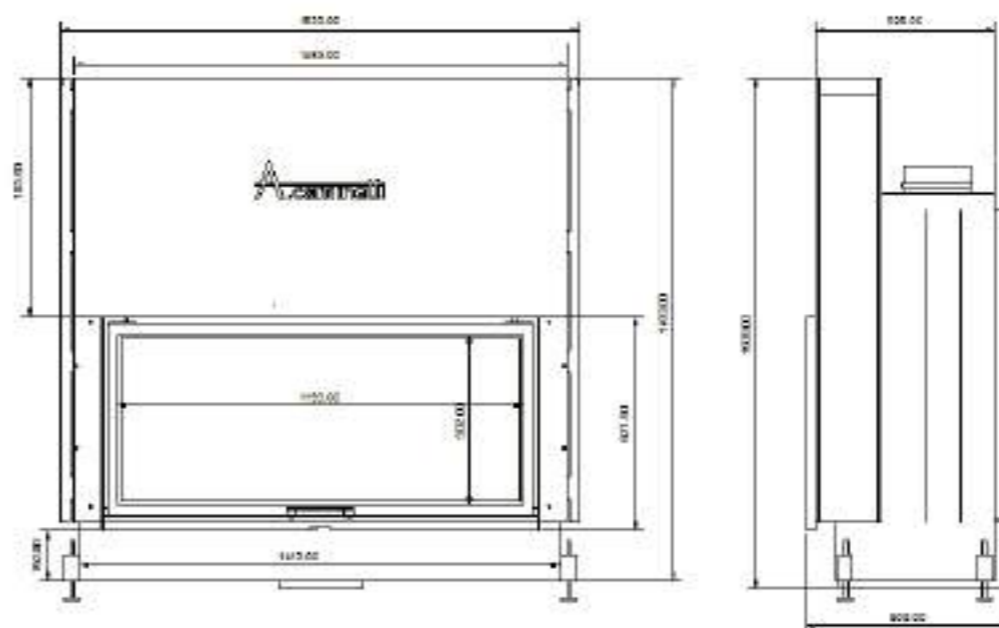

FLAT 150 X 50

A.caminetti

SERIA Flat

TECHNICAL SPECIFICATION

Model	FLAT 150 X 50
Powe (max)	15-19 kw
Outlet temperature/smoke	250°C
Efficiency	75%
Consume	3-4 kg/h
Fireplace material	Ceramic / Steel
Fan air supply	100 x 230 mm
Hot air outlet	4 x ø100 mm
Weight	420 kg
Air temperature at outlet	120°C
Fuel	Wood/Briquette
Pipe diameter	ø 250 mm
Glass	Ceramic
Certificate based on standard	UNI EN ISO 9001:2008
Weight	5 Year

OVERALL DIMENSION

Height	1500 mm
Depth	600 mm
Width	1753 mm

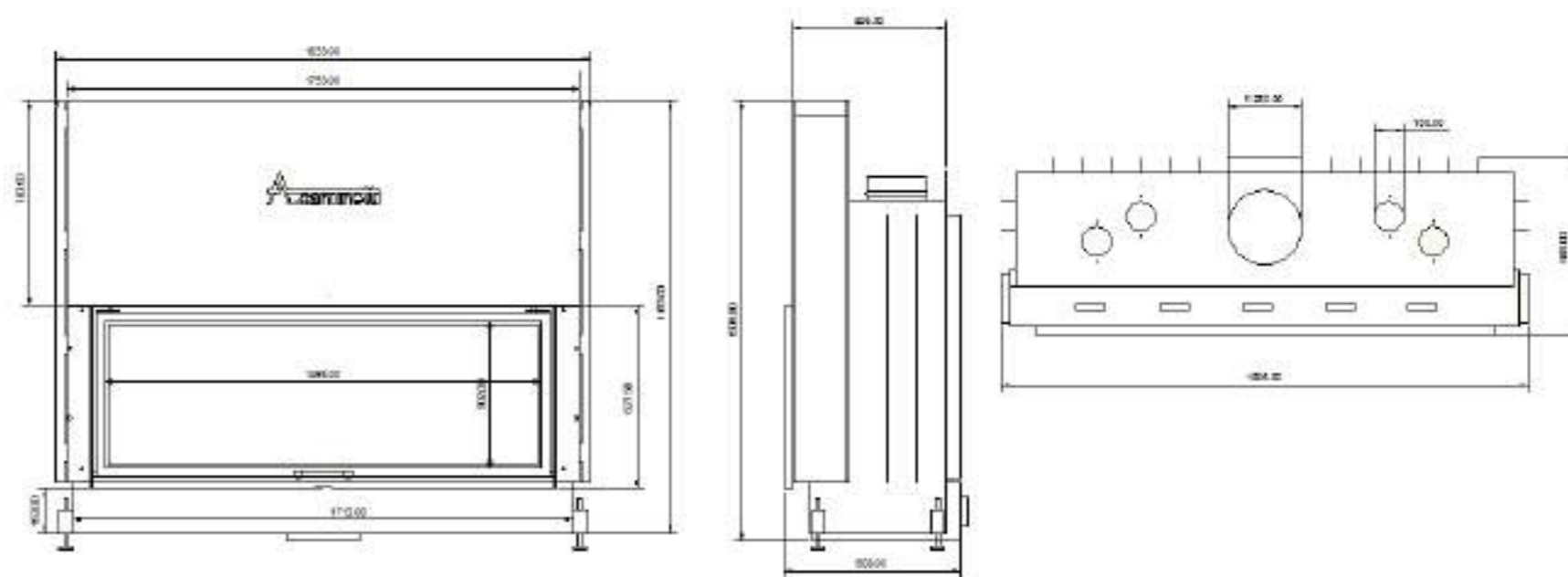

FLAT 180 X 50

A.caminetti

SERIA Flat

TECHNICAL SPECIFICATION

Model	FLAT 180x 50
Powe (max)	20 kw
Outlet temperature/smoke	270°C
Efficiency	75%
Consume	4-5 kg/h
Fireplace material	Ceramic / Steel
Fan air supply	100 x 230 mm
Hot air outlet	4 x ø100 mm
Weight	470 kg
Air temperature at outlet	120°C
Fuel	Wood/Briquette
Pipe diameter	ø 250 mm
Glass	Ceramic
Certificate based on standard	UNI EN ISO 9001:2008
Weight	5 Year

OVERALL DIMENSION

Height	1500 mm
Depth	600 mm
Width	2053 mm

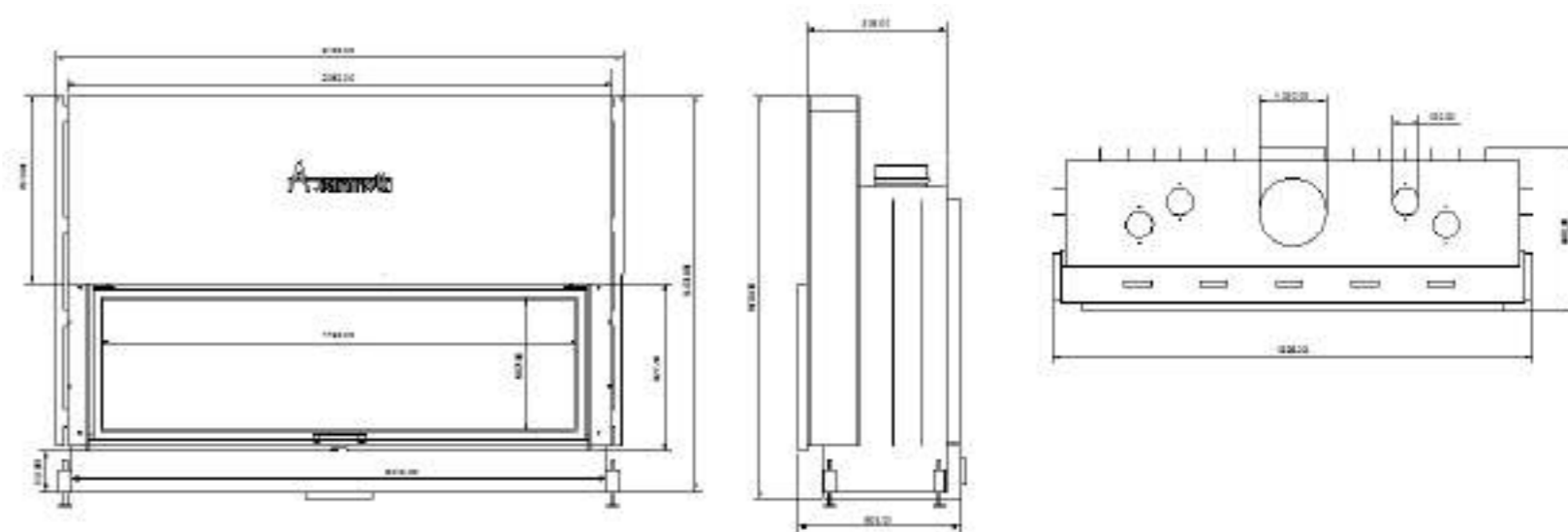

FLAT W 75 X 60

A.caminetti

SERIA Flat

TECHNICAL SPECIFICATION

Model	FLAT w 75 X 60
Powe (max)	10 kw
Outlet temperature/smoke	230°C
Efficiency	80%
Consume	2-3 kg/h
Fireplace material	Ceramic / Steel
Fan air supply	-
Hot air outlet	4 x ø100 mm
Weight	324 kg
Air temperature at outlet	120°C
Fuel	Wood/Briquette
Pipe diameter	ø 200 mm
Glass	Ceramic
Certificate based on standard	UNI EN ISO 9001:2008
Weight	5 Year

OVERALL DIMENSION

Height	1550 mm
Depth	660 mm
Width	1083 mm

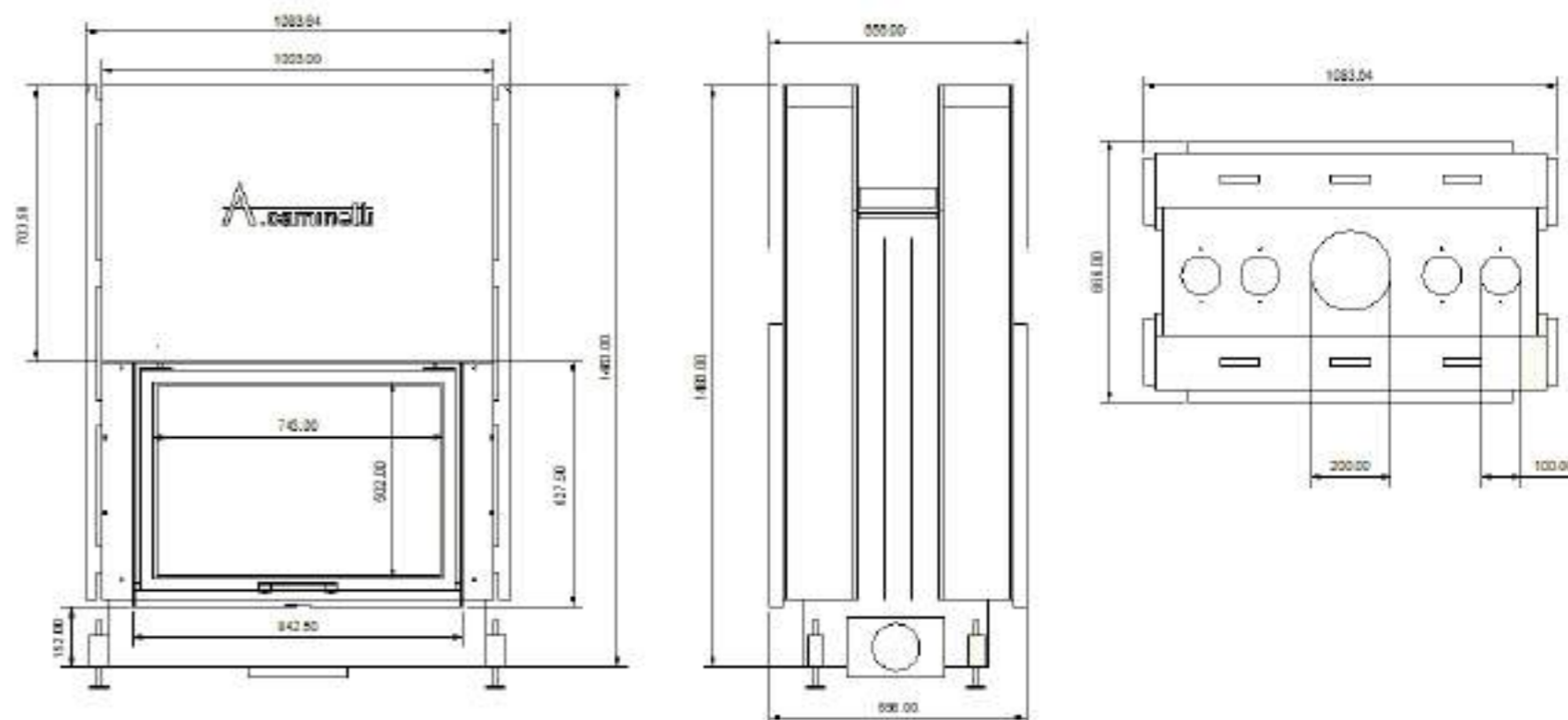

FLAT w 90 X 60

A.caminetti

SERIA Flat

TECHNICAL SPECIFICATION

Model	FLAT W 90 X 60
Powe (max)	13 kw
Outlet temperature/smoke	230°C
Efficiency	80%
Consume	2-3 kg/h
Fireplace material	Ceramic / Steel
Fan air supply	-
Hot air outlet	4 x ø100 mm
Weight	354 kg
Air temperature at outlet	120°C
Fuel	Wood/Briquette
Pipe diameter	ø 200 mm
Glass	Ceramic
Certificate based on standard	UNI EN ISO 9001:2008
Weight	5 Year

OVERALL DIMENSION

Height	1550 mm
Depth	600 mm
Width	1233 mm

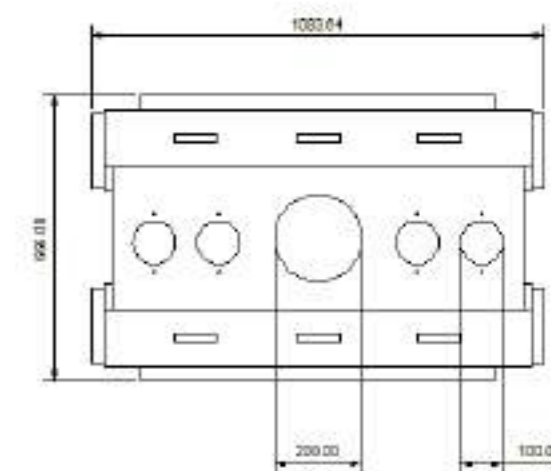
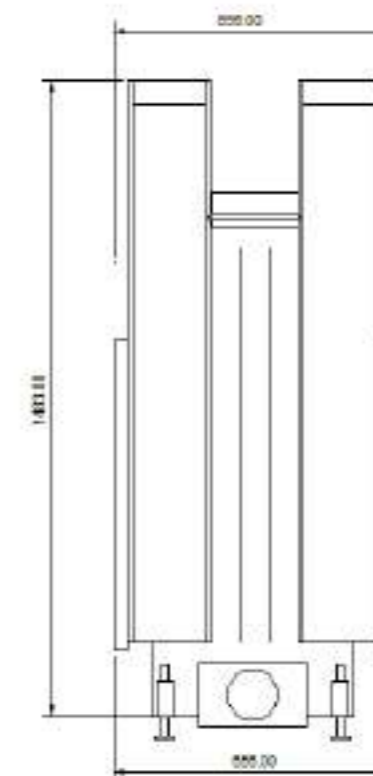
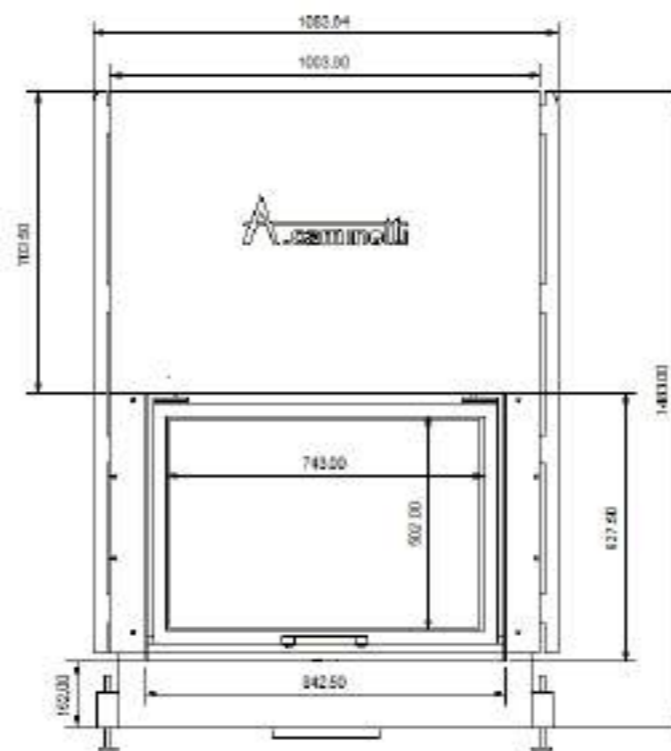

FLAT w 120 X 60

A.caminetti

SERIA Flat

TECHNICAL SPECIFICATION

Model	FLAT w 120 X 60
Powe (max)	15 kw
Outlet temperature/smoke	240°C
Efficiency	80%
Consume	3 kg/h
Fireplace material	Ceramic / Steel
Fan air supply	-
Hot air outlet	4 x ø100 mm
Weight	400 kg
Air temperature at outlet	120°C
Fuel	Wood/Briquette
Pipe diameter	ø 250 mm
Glass	Ceramic
Certificate based on standard	UNI EN ISO 9001:2008
Weight	5 Year

OVERALL DIMENSION

Height	1650 mm
Depth	660 mm
Width	1453 mm

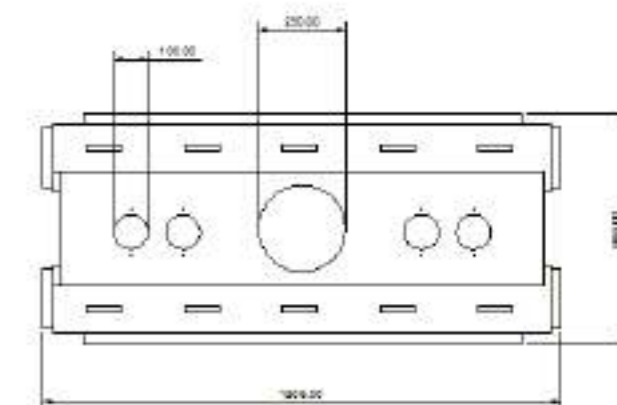
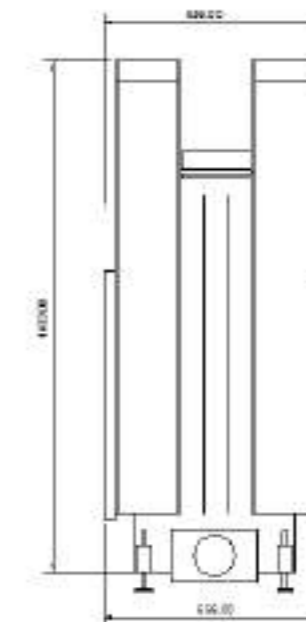
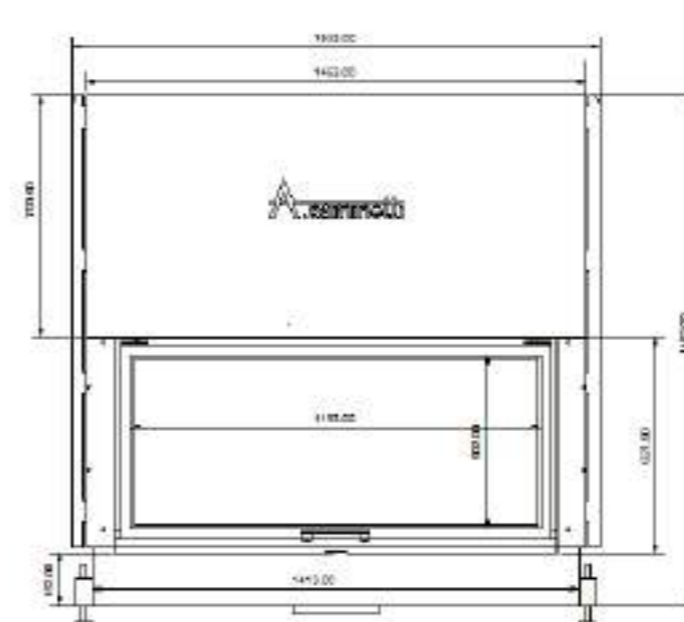

PRIZMA



A.caminetti

SERIA Prizma

TECHNICAL SPECIFICATION

Model	PRIZMA
Power (max)	13 kw
Outlet temperature/smoke	290°C
Efficiency	75%
Consume	3-4 kg/h
Fireplace Material	Ceramic/Steel
Fan air supply	100 x 230 mm
Hot air outlet	4 x ø100 mm
Weight	224 kg
Air temperature at outlet	120°C
Fuel	Wood/Briquette
Pipe diameter	ø 250 mm
Glass	Ceramic
Certificate based on standard	UNI EN ISO 9001:2008
Warranty	5 year

OVERALL DIMENSION

Height	1550 mm
Depth	550 mm
Width	990 mm

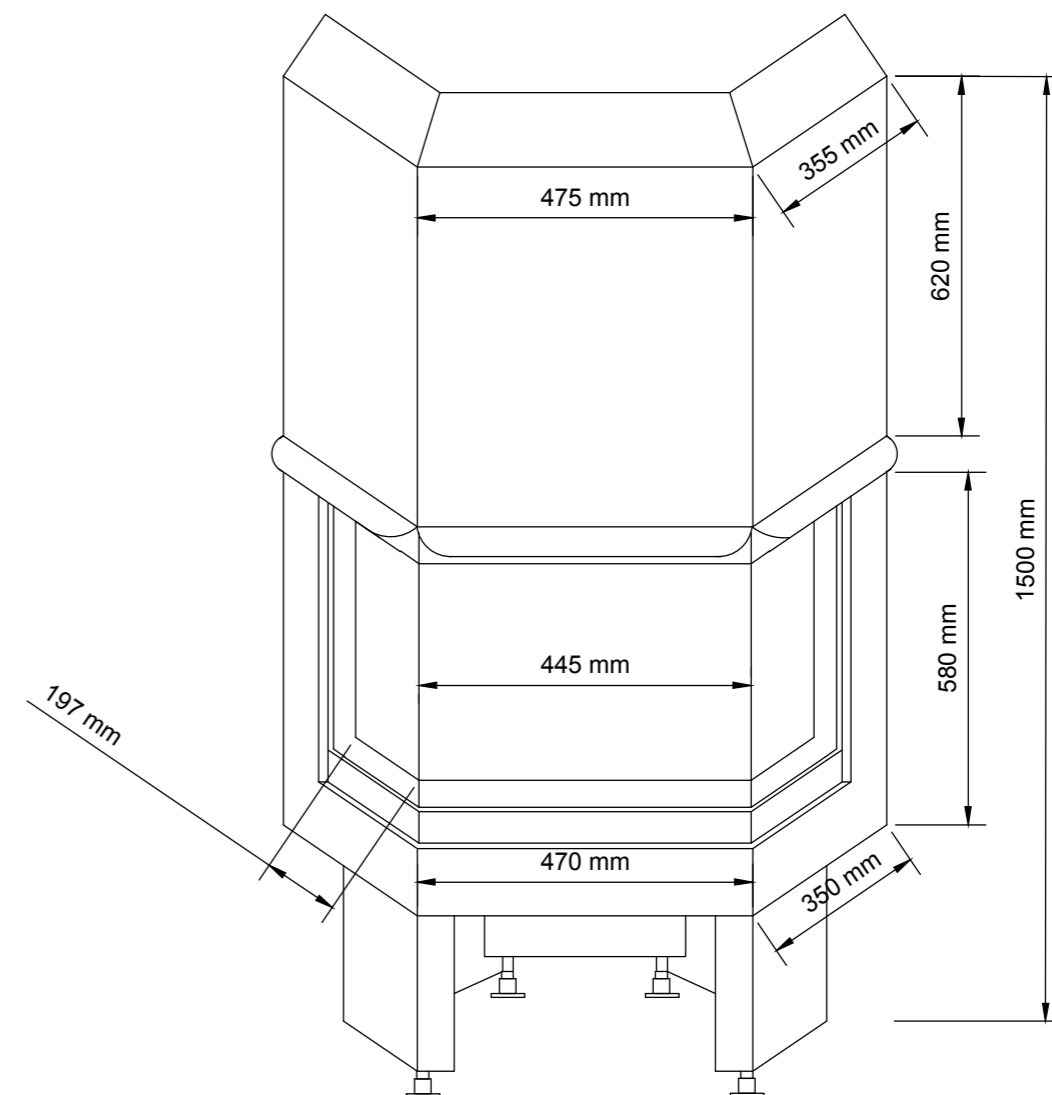

CRYSTAL 70 MAX

A.caminetti

SERIA Crystal

TECHNICAL SPECIFICATION

Model	CRYSTAL 70 MAX
Powe (max)	8-10 kw
Outlet temperature/smoke	200°C
Efficiency	80%
Consume	2-3 kg/h
Fireplace material	Ceramic / Steel
Fan air supply	100 x 230 mm
Hot air outlet	2 x ø100 mm
Weight	244 kg
Air temperature at outlet	120°C
Fuel	Wood/Briquette
Pipe diameter	ø 200 mm
Glass	Ceramic
Certificate based on standard	UNI EN ISO 9001:2008
Weight	5 Year

OVERALL DIMENSION

Height	1536 mm
Depth	600 mm
Width	730 mm

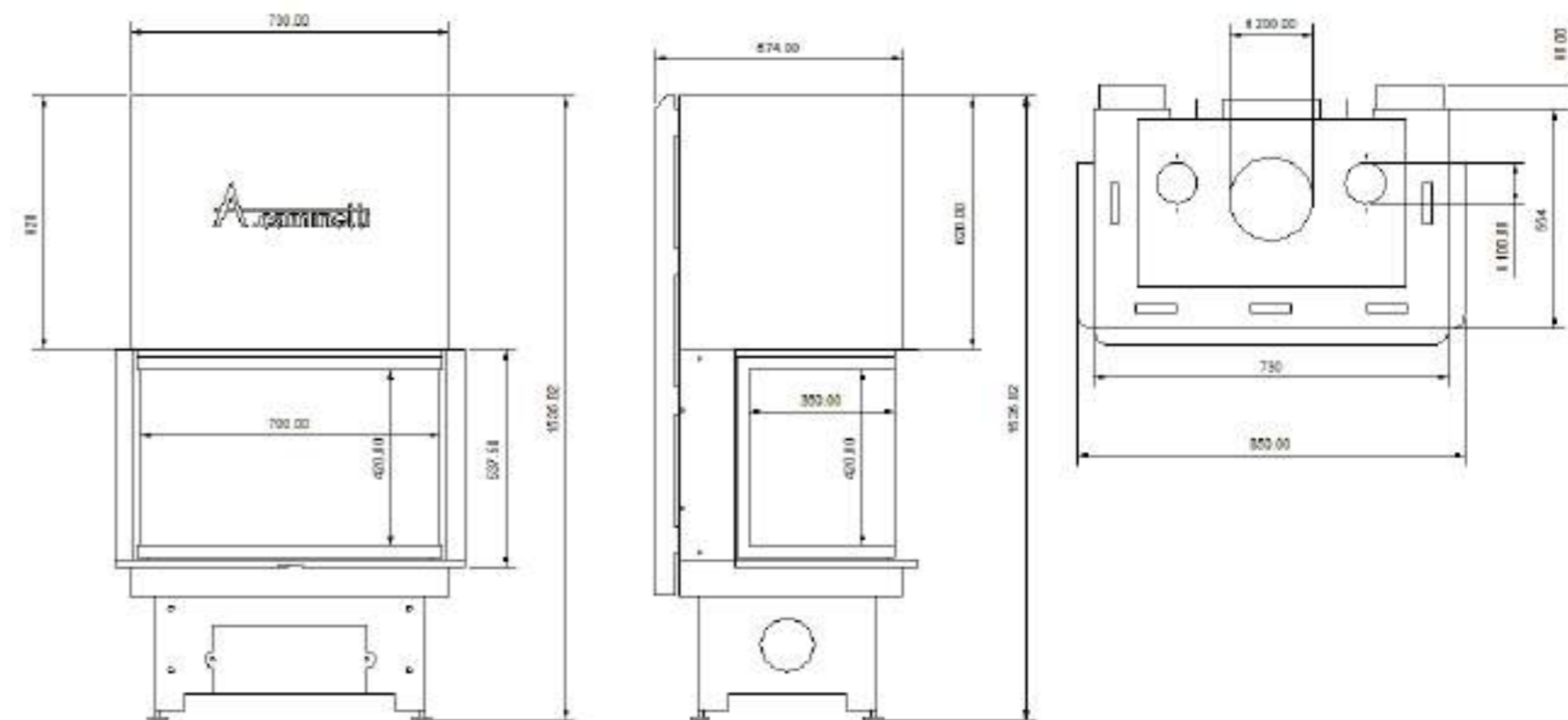

CRYSTAL 90 MAX

A.caminetti

SERIA Crystal

TECHNICAL SPECIFICATION

Model	CRYSTAL 90 MAX
Power (max)	24 kw
Outlet temperature/smoke	218°C
Efficiency	80%
Consume	3-4 kg/h
Fireplace material	Ceramic/steel
Fan air supply	100 x 230 mm
Hot air outlet	2 x ø100 mm
Weight	280 kg
Air temperature at outlet	120°C
Fuel	Wood/Briquette
Pipe diameter	ø 200 mm
Glass	Ceramic
Certificate based on standard	UNI EN ISO 9001:2008
Warranty	5 Year

OVERALL DIMENSION

Height	1536mm
Depth	613 mm
Width	890 mm

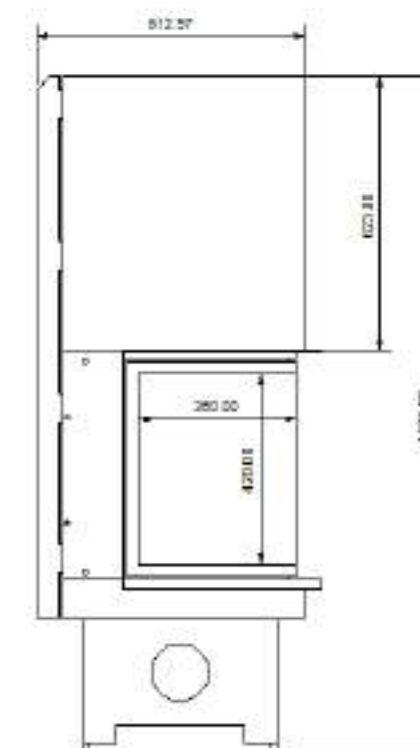
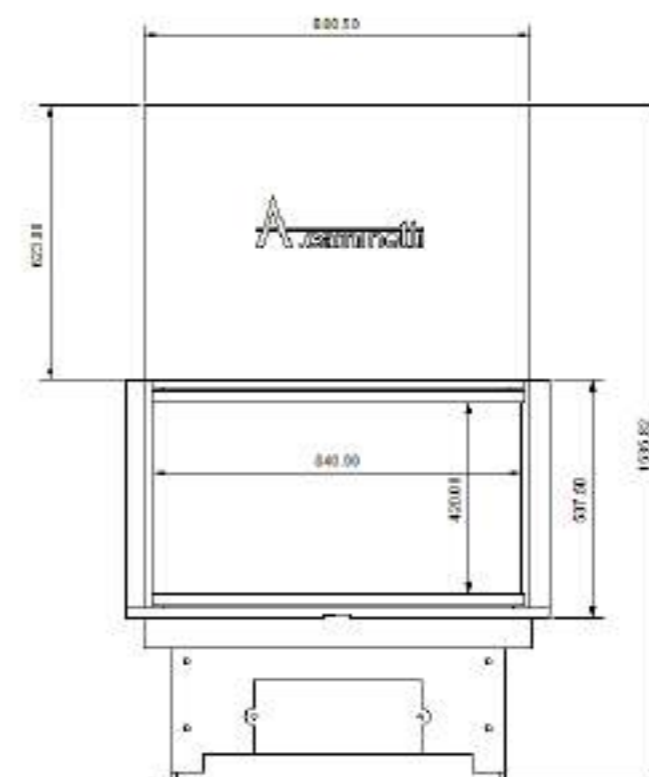
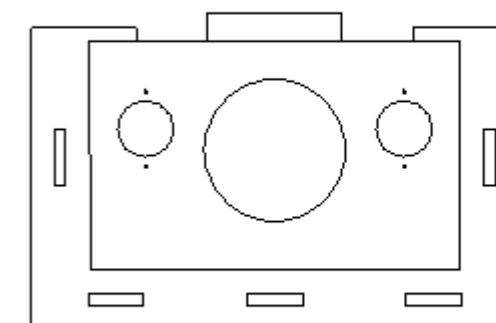

CRYSTAL 110 MAX

A.caminetti

SERIA Crystal

TECHNICAL SPECIFICATION

Model	CRYSTAL 110 MAX Power
(max)	16 kw
Outlet temperature/smoke	220°C
Efficiency	80%
Consume	3-4 kg/h
Fireplace material	Ceramic /Steel
Fan air supply	100 x 230 mm
Hot air outlet	2 x ø100 mm
Weight	327 kg
Air temperature at outlet	120°C
Fuel	Wood/Briquette
Pipe diameter	ø 200 mm
Glass	Ceramic
Certificate based on standard	UNI EN ISO 9001:2008
Warranty	5 year

OVERALL DIMENSION

Height	1550 mm
Depth	612 mm
Width	1150 mm

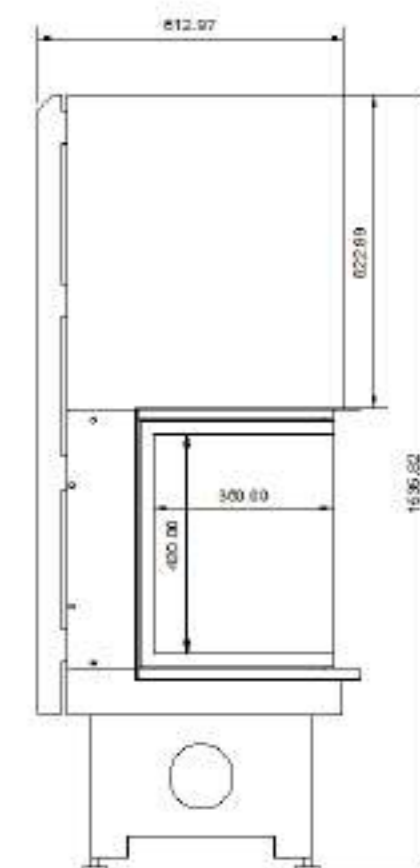
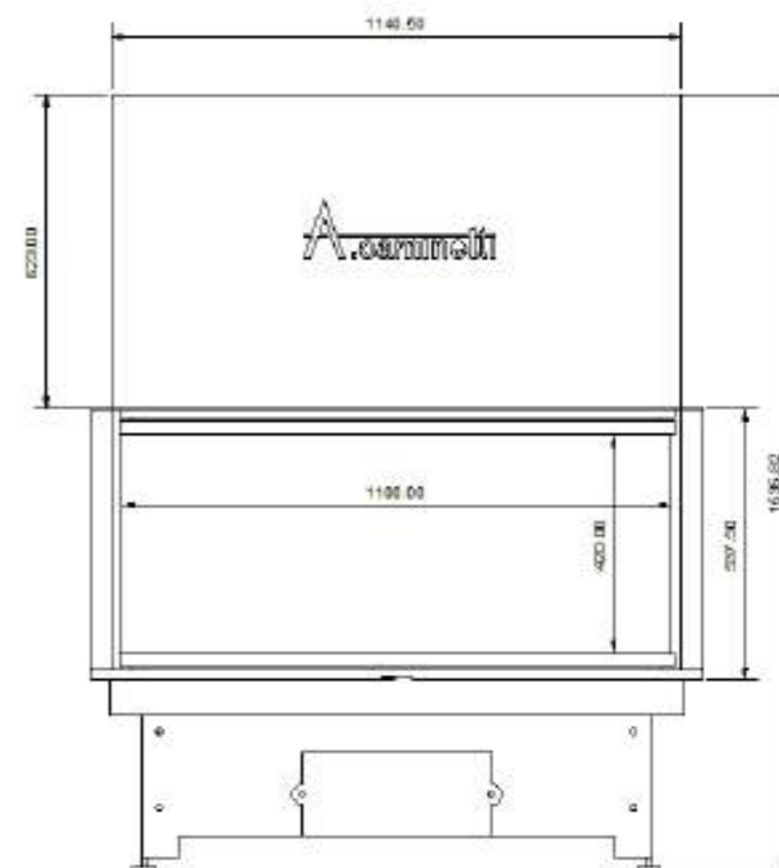
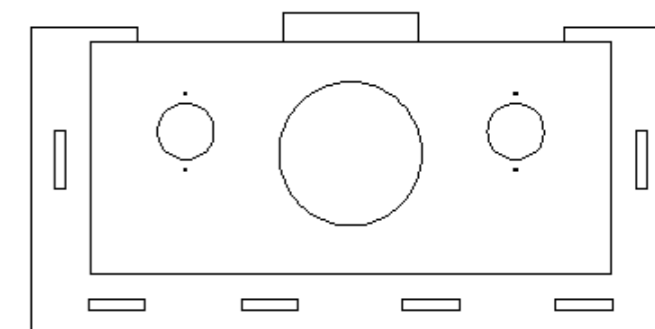

TECHNICAL SPECIFICATION

Model	CRYSTAL 3D 50/60
Powe (max)	8-10 kw
Outlet temperature/smoke	200°C
Efficiency	80%
Consume	2-3 kg/h
Fireplace material	Ceramic / Steel
Fan air supply	100 x 230 mm
Hot air outlet	2 x ø100 mm
Weight	240 kg
Air temperature at outlet	120°C
Fuel	Wood/Briquette
Pipe diameter	ø 200 mm
Glass	Ceramic
Certificate based on standard	UNI EN ISO 9001:2008
Weight	5 Year

OVERALL DIMENSION

Height	1530 mm
Depth	917 mm
Width	535 mm

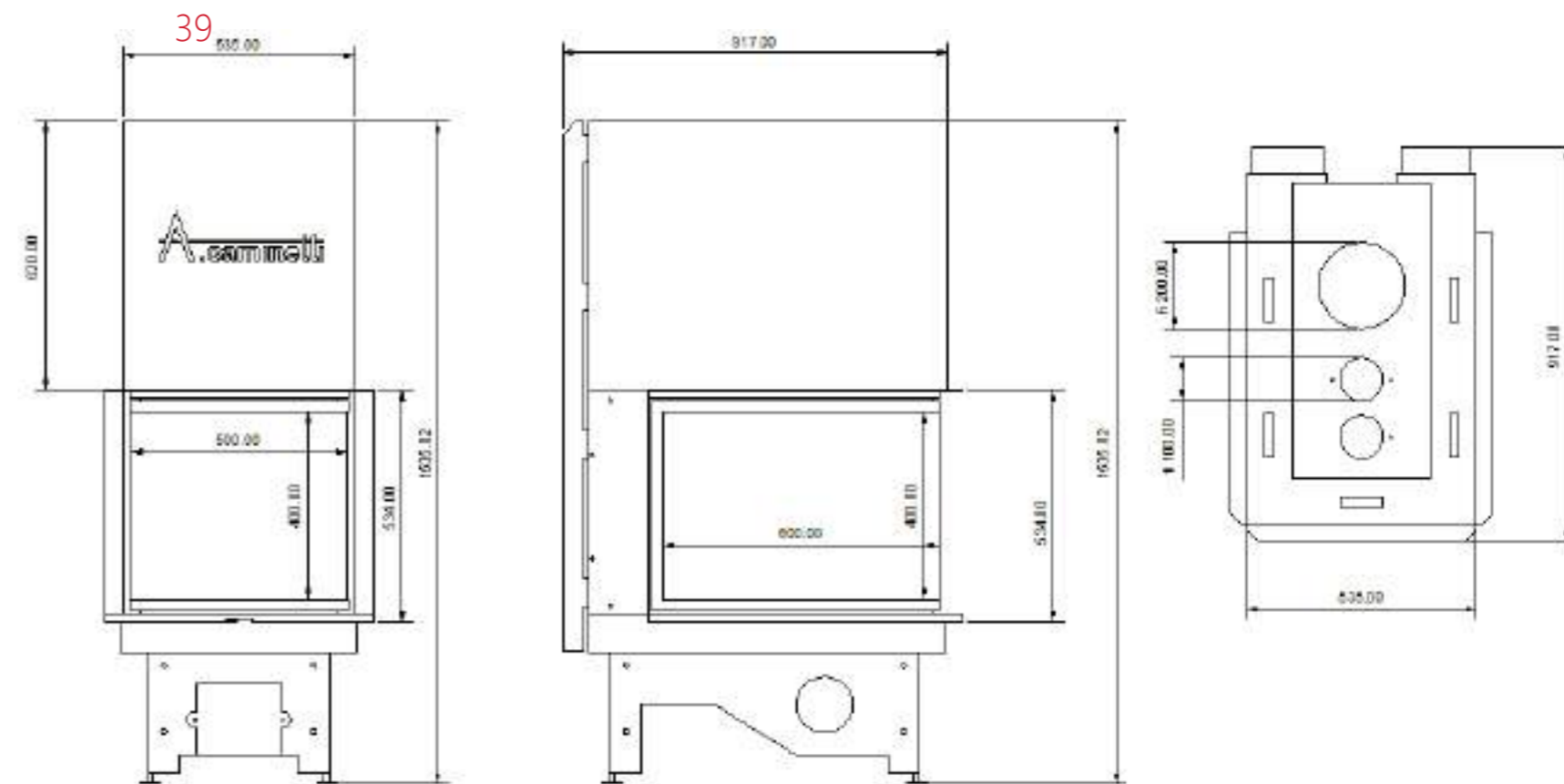

CRYSTAL 3D 50/70

A.caminetti

SERIA Flat

TECHNICAL SPECIFICATION

Model	CRYSTAL 3D 50/70
Powe (max)	12 kw
Outlet temperature/smoke	200°C
Efficiency	80 %
Consume	2-3 kg/h
Fireplace material	Ceramic / Steel
Fan air supply	100 x 230 mm
Hot air outlet	2 x ø100 mm
Weight	285 kg
Air temperature at outlet	120°C
Fuel	Wood/Briquette
Pipe diameter	ø 200 mm
Glass	Ceramic
Certificate based on standard	UNI EN ISO 9001:2008
Weight	5 Year

OVERALL DIMENSION

Height	1530 mm
Depth	1,017 mm
Width	535 mm

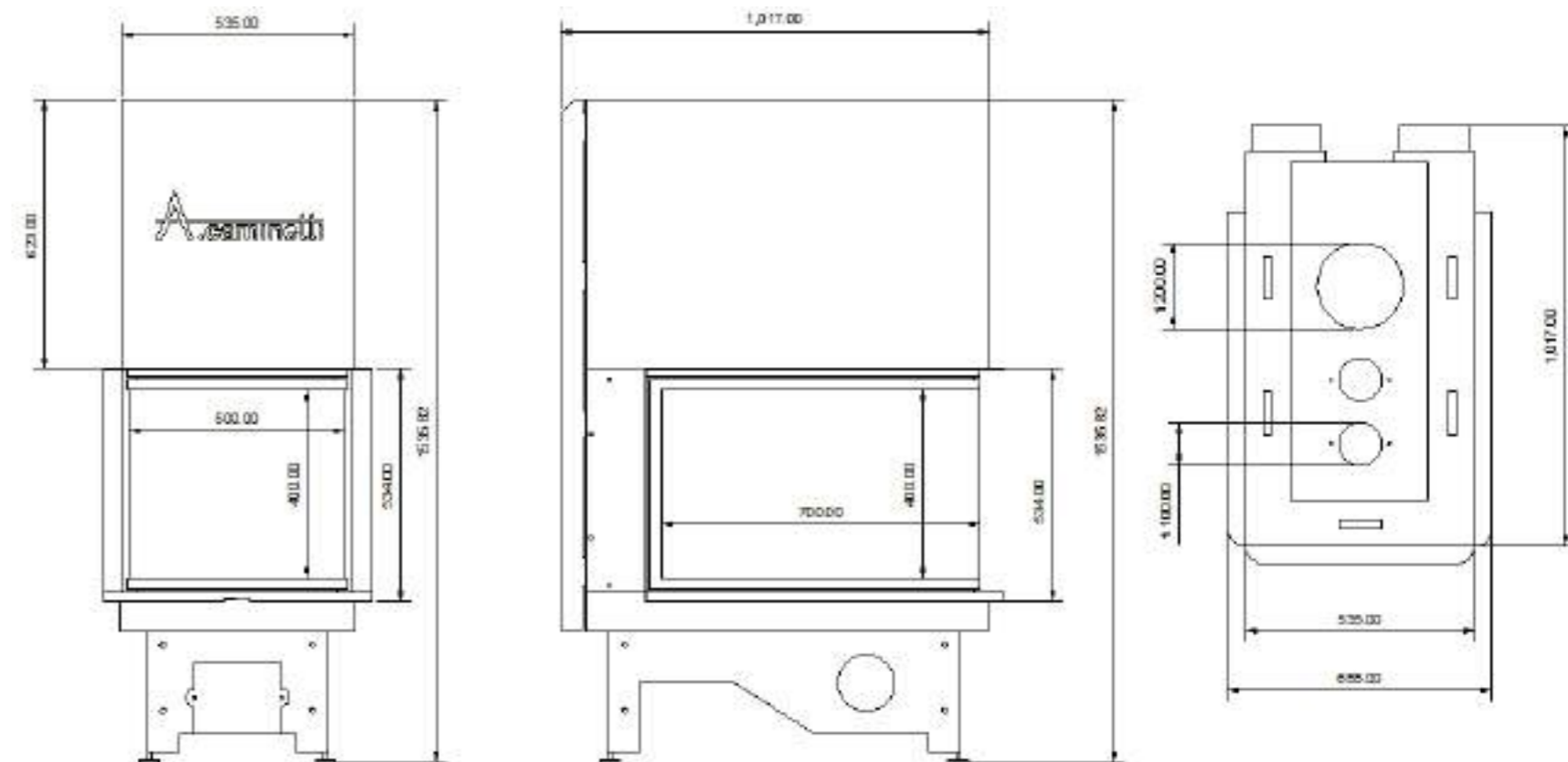

CRYSTAL 3D

A.caminetti

SERIA Crystal

TECHNICAL SPECIFICATION

Model	CRYSTAL 3D
Power (max)	12 kw
Outlet temperature/smoke	230°C
Efficiency	80%
Consume	3-4 kg/h
Fireplace material	Ceramic/Steel
Fan air supply	100 x 230 mm
Hot air outlet	2 x ø100 mm
Weight	308 kg
Air temperature at outlet	120°C
Fuel	Wood/Briquette
Pipe diameter	ø 200 mm
Glass	Ceramic
Certificate based on standard	UNI EN ISO 9001:2008
Weight	5 Weight

OVERALL DIMENSION

Height	1536mm
Depth	993 mm
Width	639 mm

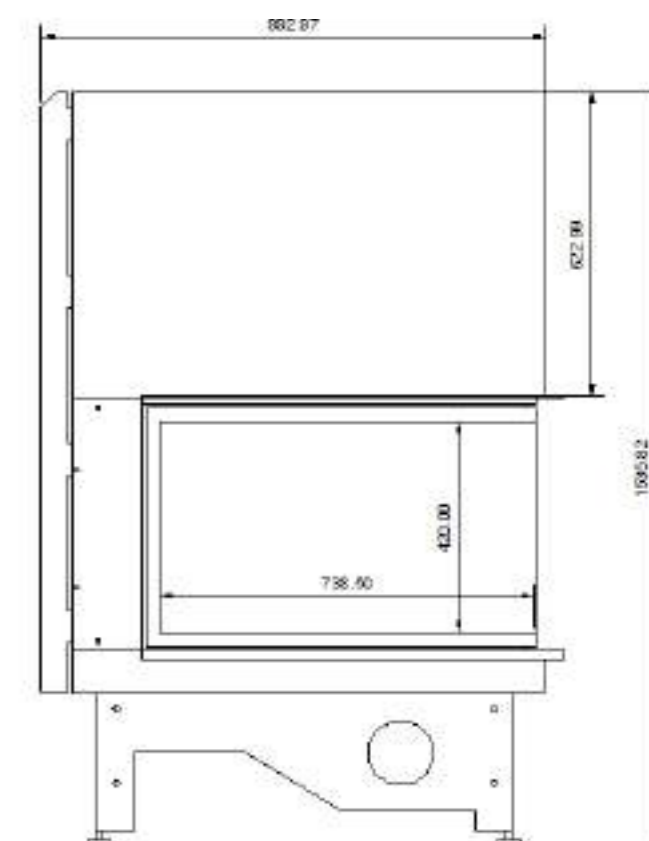
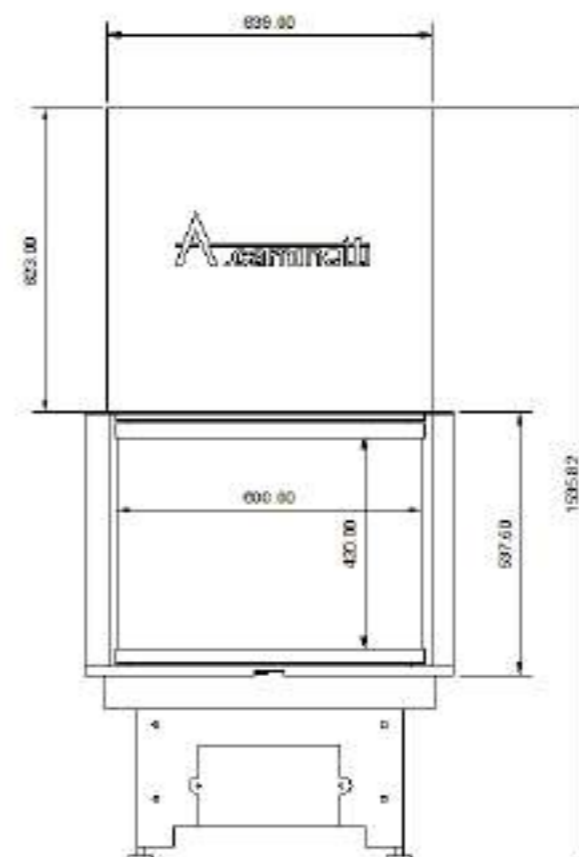
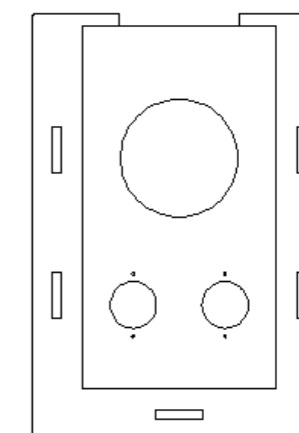

CRYSTAL 3D max

A.caminetti

SERIA Crystal

TECHNICAL SPECIFICATION

Model	CRYSTAL 3D max
Power (max)	16 kw
Outlet temperature/smoke	220°C
Efficiency	80%
Consume	3-4 kg/h
Fireplace material	Ceramic/Steel
Fan air supply	100 x 230 mm
Hot air outlet	2 x ø100 mm
Weight	350 kg
Air temperature at outlet	120°C
Fuel	Wood/Briquette
Pipe diameter	ø 250 mm
Glass	Ceramic
Certificate based on standard	UNI EN ISO 9001:2008
Warranty	5 Year

OVERALL DIMENSION

Height	1540 mm
Depth	639 mm
Width	1173 mm

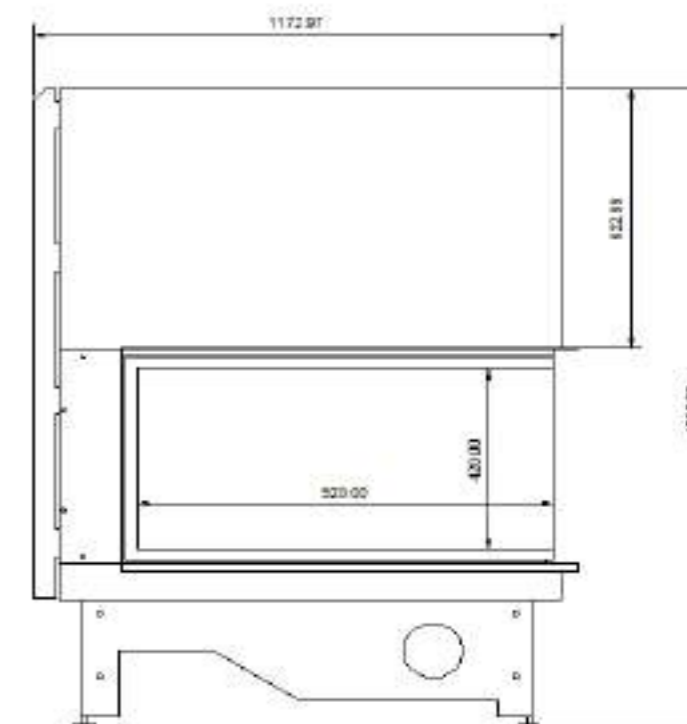
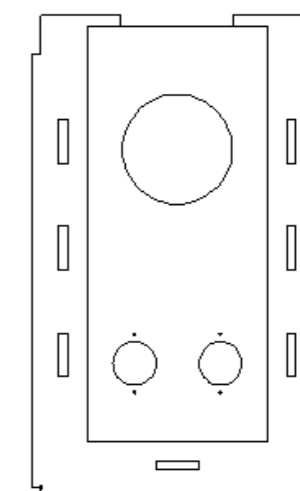

CRYSTAL 4D



A.caminetti

SERIA Crystal

TECHNICAL SPECIFICATION

Model	CRYSTAL 4D
Power (max)	20 kw
Outlet temperature/smoke	290°C
Efficiency	75%
Consume	3-4 kg/h
Fireplace material	Ceramic/Steel
Fan air supply	—
Hot air outlet	—
Weight	280 kg
Air temperature at outlet	120°C
Fuel	Wood/Briquette
Pipe diameter	ø 250 mm
Glass	Ceramic
Certificate based on standard	UNI EN ISO 9001:2008
Warranty	5 Year

OVERALL DIMENSION

Height	1650 mm
Depth	810 mm
Width	1130 mm

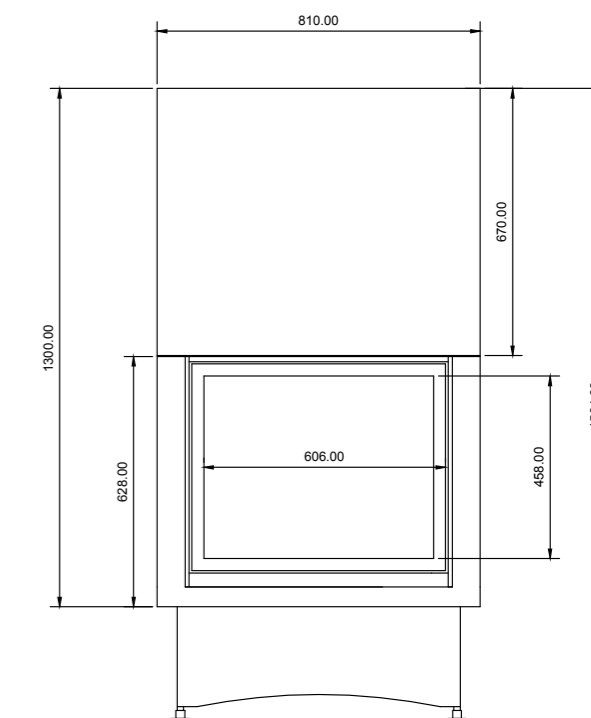
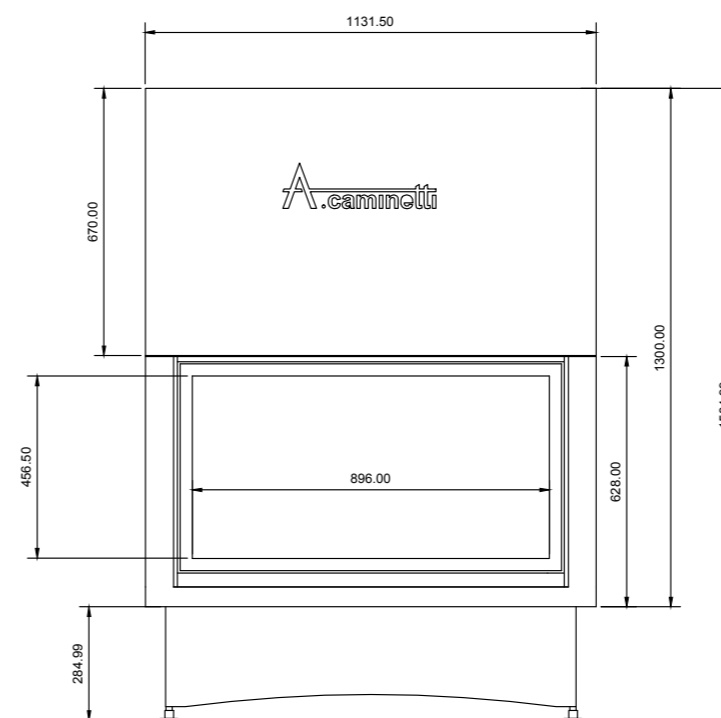

QUATTRO L80

A.caminetti

SERIA Quattro

TECHNICAL SPECIFICATION

OVERALL DIMENSION

Model	QUATTRO L80
Powe (max)	7-10 kw
Outlet temperature/smoke	200°C
Efficiency	80%
Consume	2-3 kg/h
Fireplace material	Ceramic / Steel
Fan air supply	100 x 230 mm
Hot air outlet	2 x ø100 mm
Weight	255 kg
Air temperature at outlet	120°C
Fuel	Wood/Briquette
Pipe diameter	ø 200 mm
Glass	Ceramic
Certificate based on standard	UNI EN ISO 9001:2008
Weight	5 Year

Height	1550 mm
Depth	600 mm
Width	875 mm

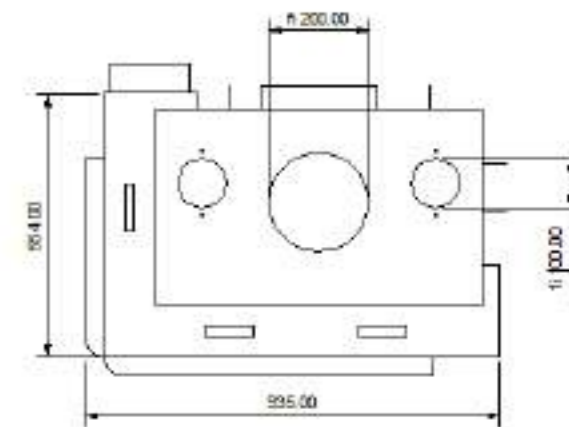
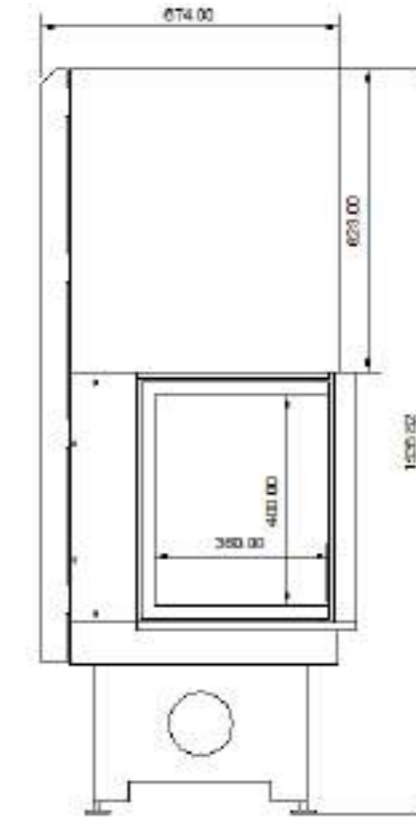
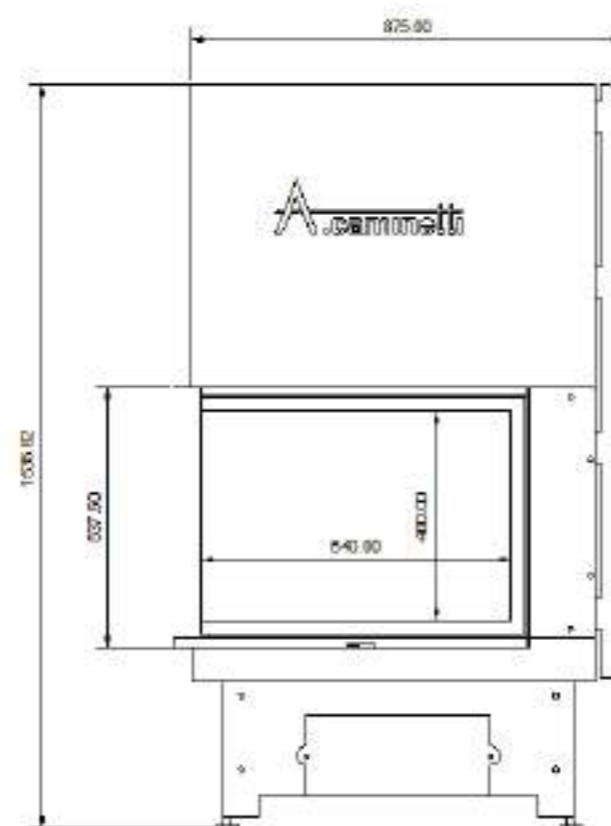

QUATTRO R80

A.caminetti

SERIA Quattro

TECHNICAL SPECIFICATION

Model	QUATTRO R80
Powe (max)	7-10 kw
Outlet temperature/smoke	200°C
Efficiency	80%
Consume	2-3 kg/h
Fireplace material	Ceramic / Steel
Fan air supply	100 x 230 mm
Hot air outlet	2 x ø100 mm
Weight	255 kg
Air temperature at outlet	120°C
Fuel	Wood/Briquette
Pipe diameter	ø 200 mm
Glass	Ceramic
Certificate based on standard	UNI EN ISO 9001:2008
Weight	5 Year

OVERALL DIMENSION

Height	1550 mm
Depth	600 mm
Width	875 mm

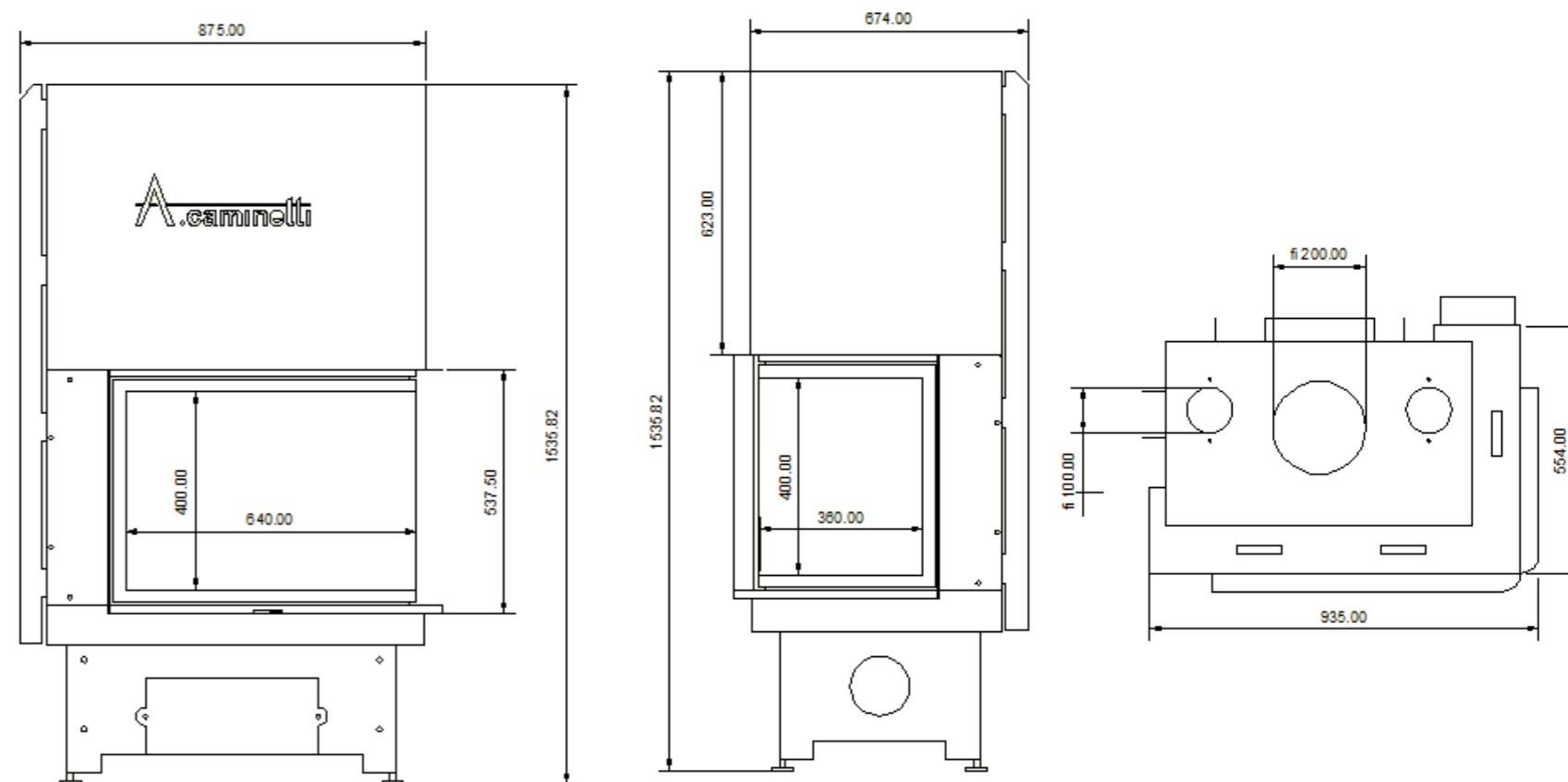

QUATTRO L90 MAX

A.caminetti

SERIA Quattro

TECHNICAL SPECIFICATION

Model	QUATTRO L90 MAX
Power (max)	8-12 kw
Outlet temperature/smoke	200°C
Efficiency	80%
Consume	2-3 kg/h
Fireplace Material	Ceramic/Steel
Fan air supply	100 x 230 mm
Hot air outlet	2 x \varnothing 100 mm
Weight	285 kg
Air temperature at outlet	120°□
Fuel	Wood/Briquette
Pipe diameter	\varnothing 200 mm
Glass	Ceramic
Certificate based on standard	UNI EN ISO 9001:2008
Warranty	5 Year

OVERALL DIMENSION

Height	1536mm
Depth	613 mm
Width	993 mm

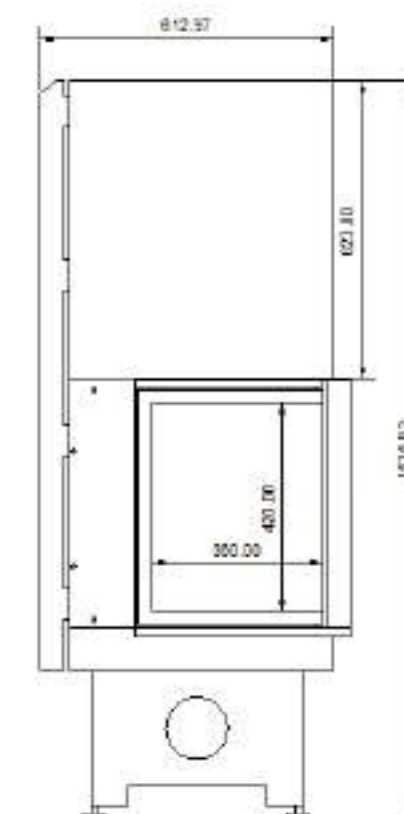
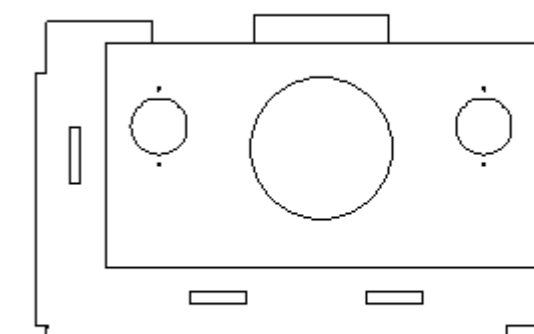

QUATTRO R90 MAX

A.caminetti

SERIA Quattro

TECHNICAL SPECIFICATION

Model	QUATTRO R90 MAX
Power (max)	8-12 kw
Outlet temperature/smoke	200°C
Efficiency	80%
Consume	2-3 kg/h
Fireplace material	Ceramic/Steel
Fan air supply	100 x 230 mm
Hot air outlet	2 x \varnothing 100 mm
Weight	285 kg
Air temperature at outlet	120°C
Fuel	Wood/Briquette
Pipe diameter	\varnothing 200 mm
Glass	Ceramic
Certificate based on standard	UNI EN ISO 9001:2008
Weight	5 Year

OVERALL DIMENSION

Height	1536mm
Depth	613 mm
Width	993 mm

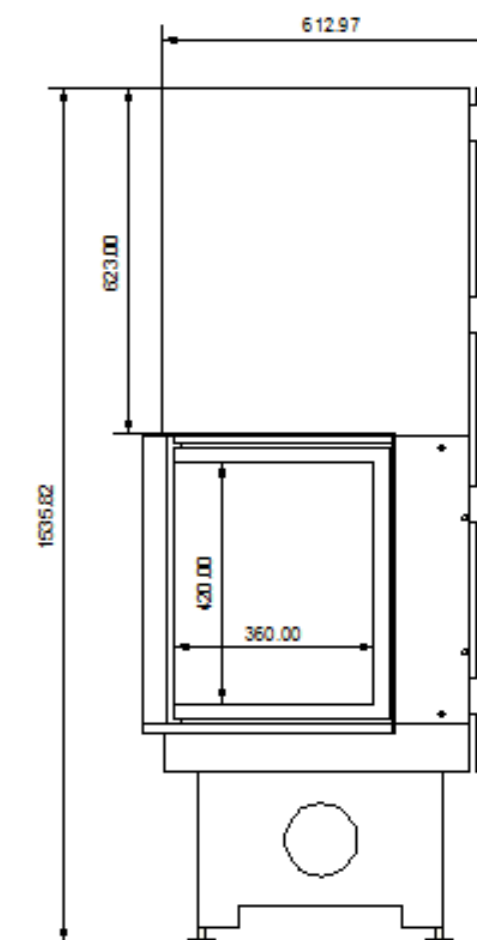
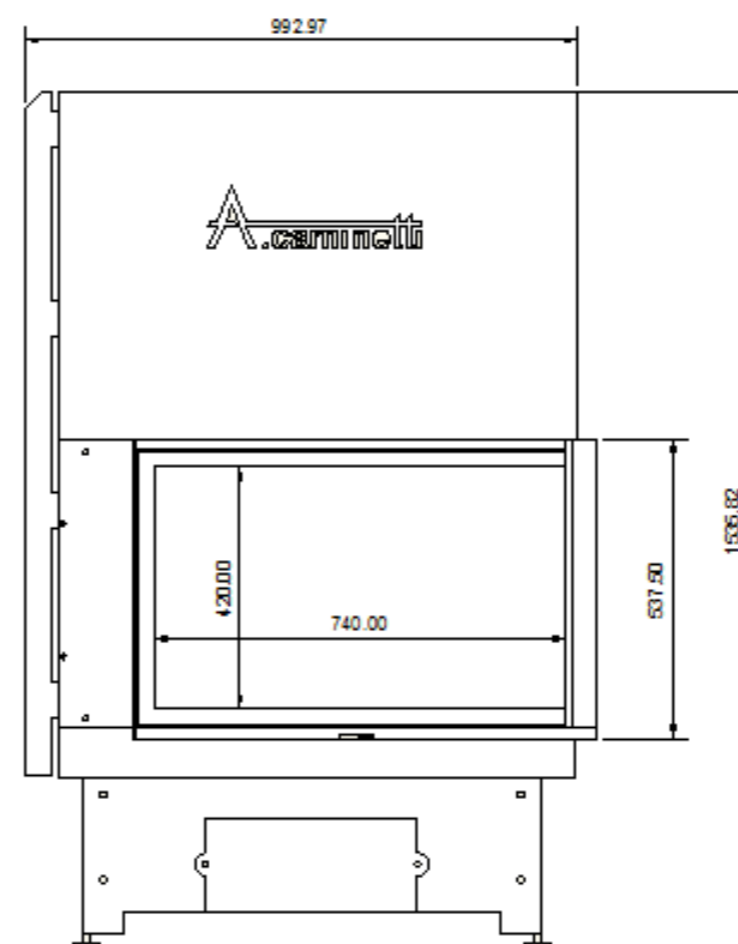
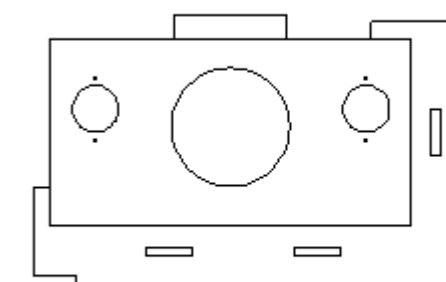

QUATTRO R100

A.caminetti

SERIA Quattro

TECHNICAL SPECIFICATION

Model	QUATTRO R90
Power (max)	10-18 kw
Outlet temperature/smoke	220°C
Efficiency	80 %
Consume	3-4 kg/h
Fireplace material	Ceramic /Steel
Fan air supply	100 x 230 mm
Hot air outlet	2 x ø100 mm
Weight	310 kg
Air temperature at outlet	120°C
Fuel	Wood/Briquette
Pipe diameter	ø 250 mm
Glass	Ceramic
Certificate based on standard	UNI EN ISO 9001:2008
Warranty	5 year

OVERALL DIMENSION

Height	1540mm
Depth	612 mm
Width	1252 mm

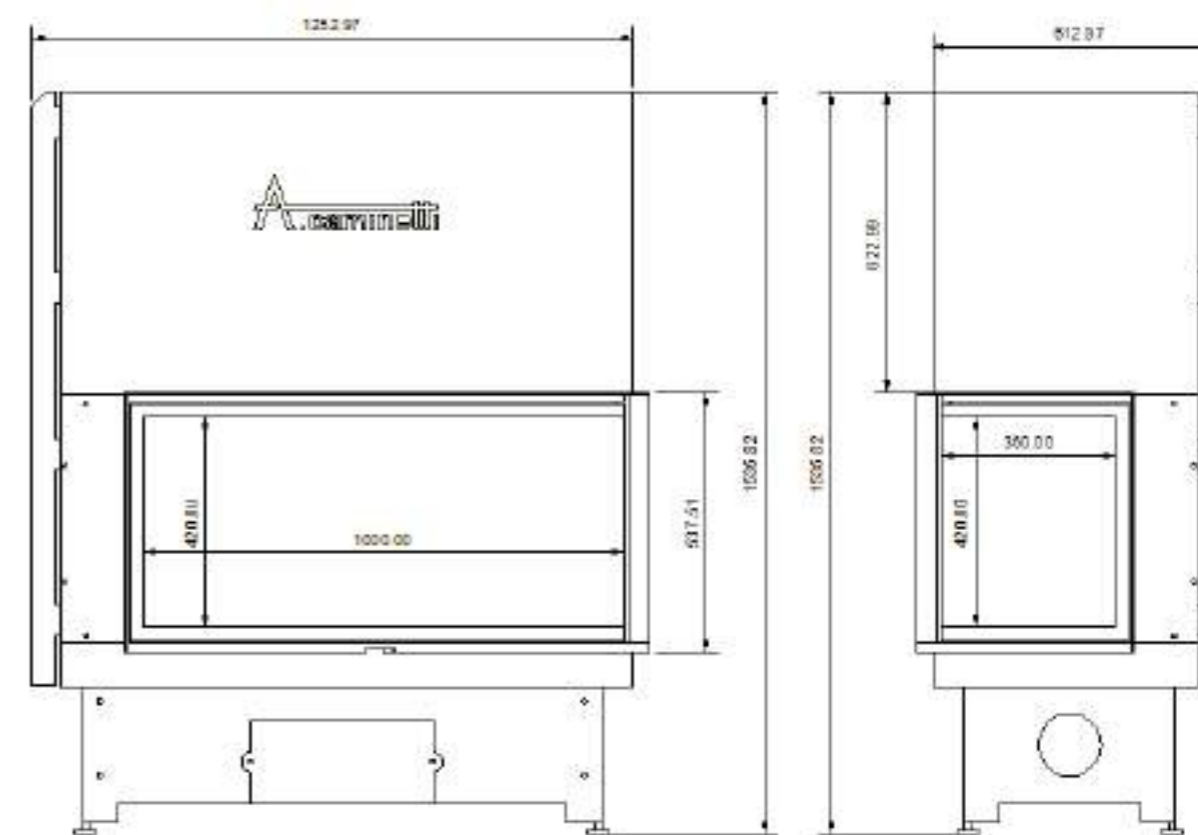
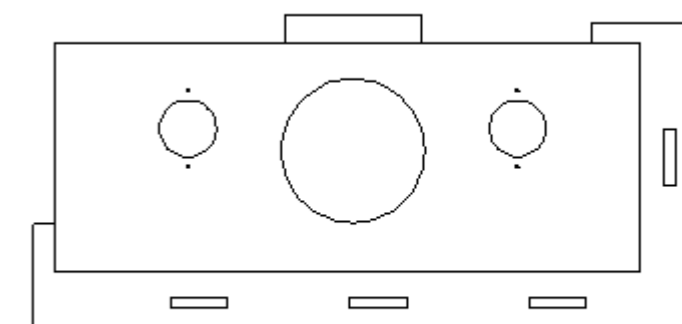

QUATTRO L100

A.caminetti

SERIA Quattro

TECHNICAL SPECIFICATION

Model	QUATTRO L100
Power (max)	10-18 kw
Outlet temperature/smoke	220°C
Efficiency	80 %
Consume	3-4 kg/h
Fireplace material	Ceramic/Steel
Fan air supply	100 x 230 mm
Hot air outlet	2 x Ø100 mm
Weight	310 kg
Air temperature at outlet	120°C
Fuel	Wood/Briquette
Pipe diameter	Ø 250 mm
Glass	Ceramic
Certificate based on standard	UNI EN ISO 9001:2008
Warranty	5 Year

OVERALL DIMENSION

Height	1540mm
Depth	612 mm
Width	1252 mm

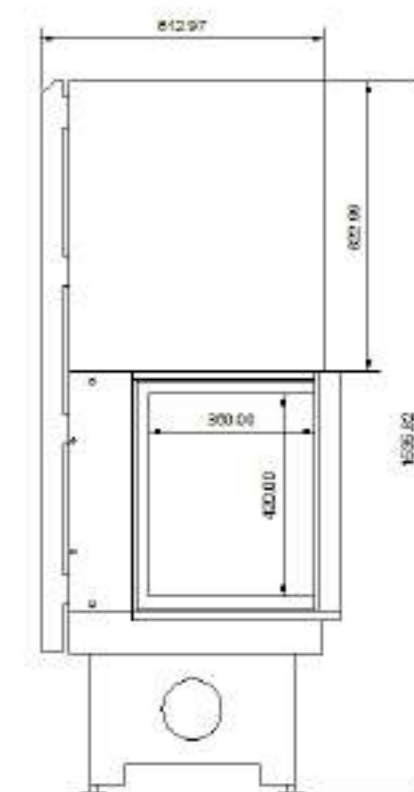
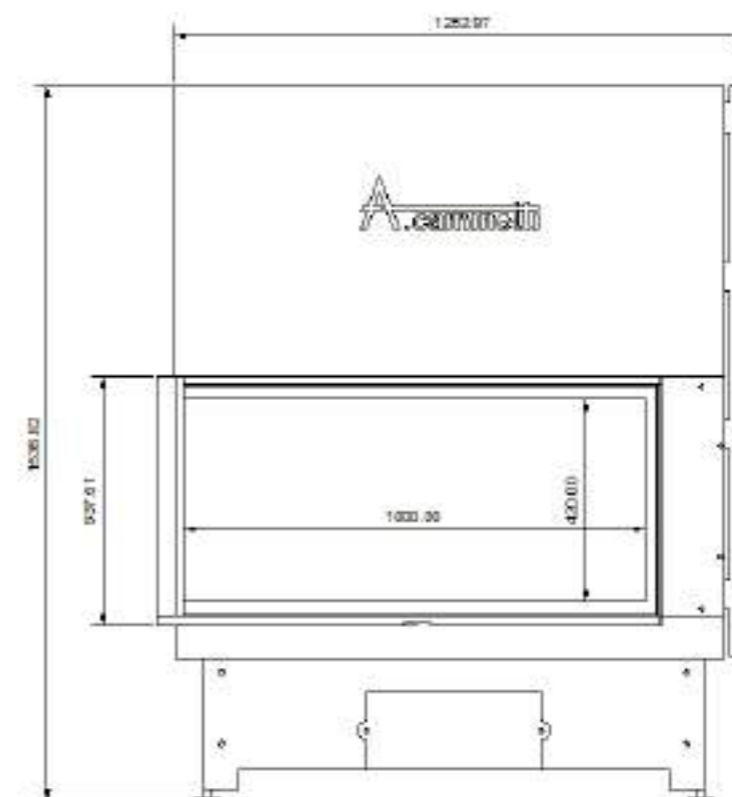
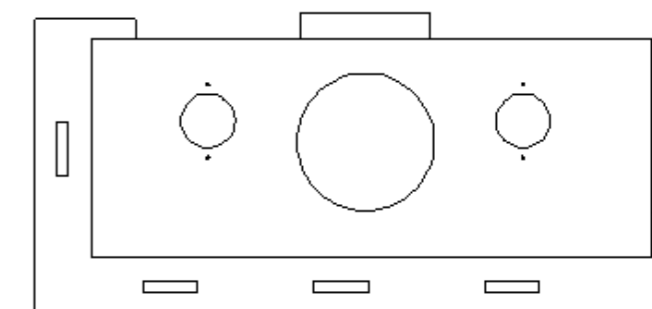



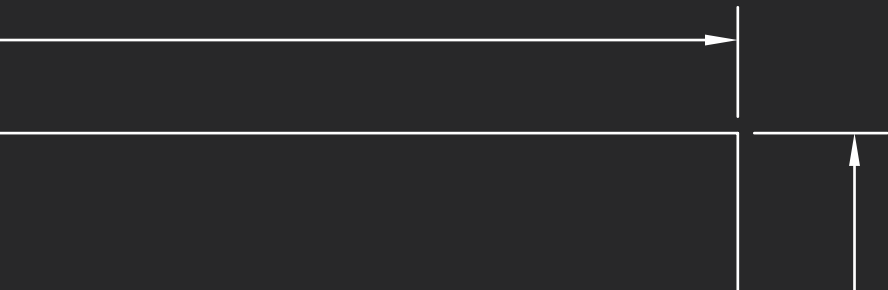

A.caminetti

 www.acaminetti-factory.com

